

REVISIONS				
NO.	DATE	REMARKS	BY	APPD.

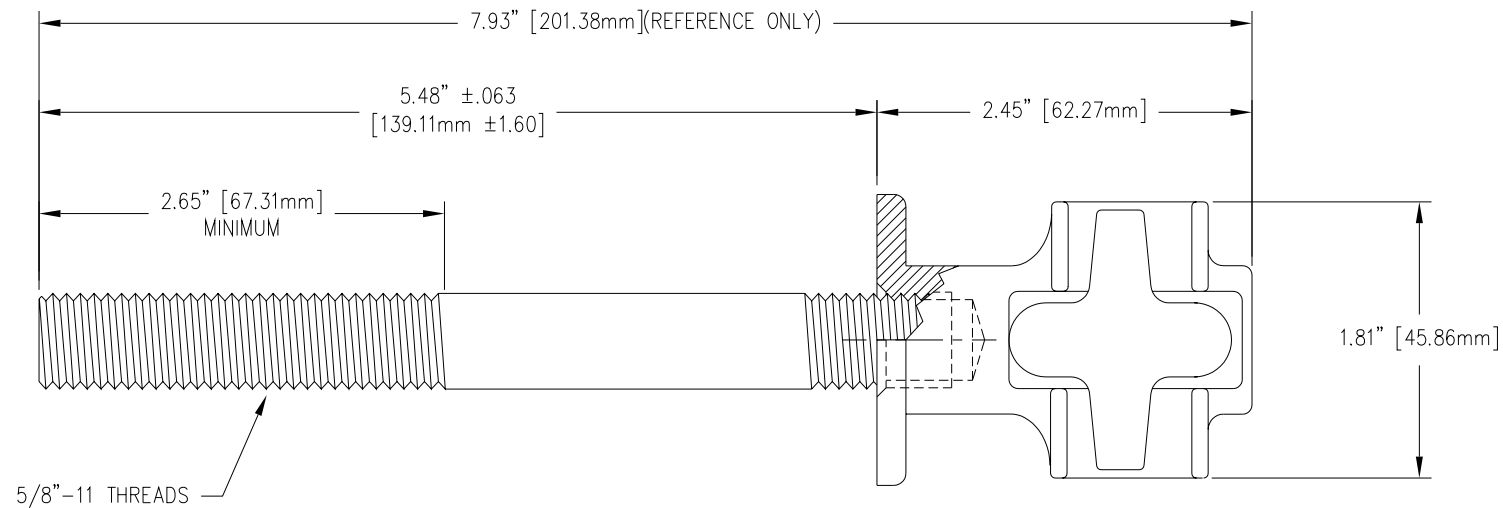

5/8"-11 THREADS

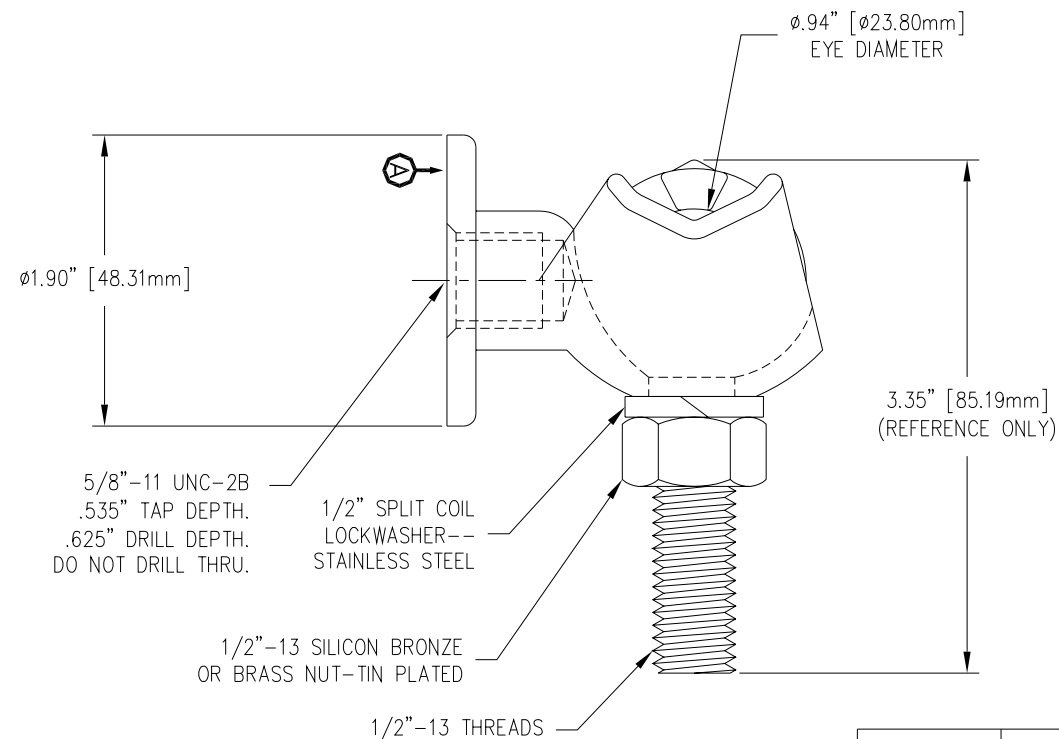
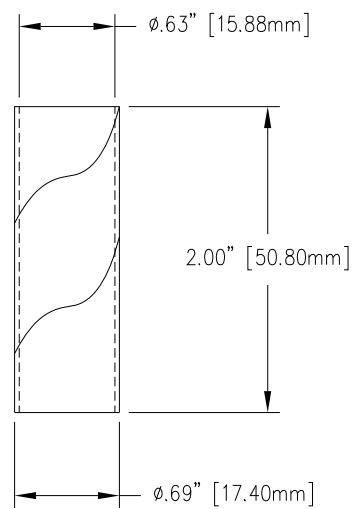

5/8"-11 UNC-2B
.535" TAP DEPTH.
.625" DRILL DEPTH.
DO NOT DRILL THRU.

1/2" SPLIT COIL
LOCKWASHER--
STAINLESS STEEL

1/2"-13 SILICON BRONZE
OR BRASS NUT-TIN PLATED

1/2"-13 THREADS

NOTES:
BOTTOM VIEW SHOWN WITHOUT
STUD FOR DIMENSIONING.

MATERIAL:
STUD - COPPER CDA 110
BODY - CDA 844 TIN PLATED
EYEBOLT - CDA 955 TIN PLATED

NOTE:
FULL THREAD FROM SURFACE
TO THE DEPTH SPECIFIED IN THE TAP NOTE.



TOLERANCES (EXCEPT AS NOTED)				H-J ENTERPRISES, INC. 3010 HIGH RIDGE BLVD. HIGH RIDGE, MO. 63049 USA PHONE 1-636-677-3421 FAX 1-636-376-1915	
DECIMAL	± .032" / .8mm			5/8"-11 X 6.125" STUD AND TERMINAL BODY ASSEMBLY	
FRACTIONAL	±	MATERIAL (SEE ABOVE)		CHK'D	APP'D
ANGULAR	± 2°	DRAWN BY	DATE	SCALE	DRAWING NO.
		CJT	9-28-98	N.T.S.	AS1064-002