

REVISIONS					
NO.	DATE	ECN #	REMARKS	BY	APPD.
1	1-3-00		EDITED AND ADDED DIMS. AND ADDED TAP DEPTH.	CJT	LHE
2	3-9-04	HJ04-050	ADDED A NOTE	JRM	SP

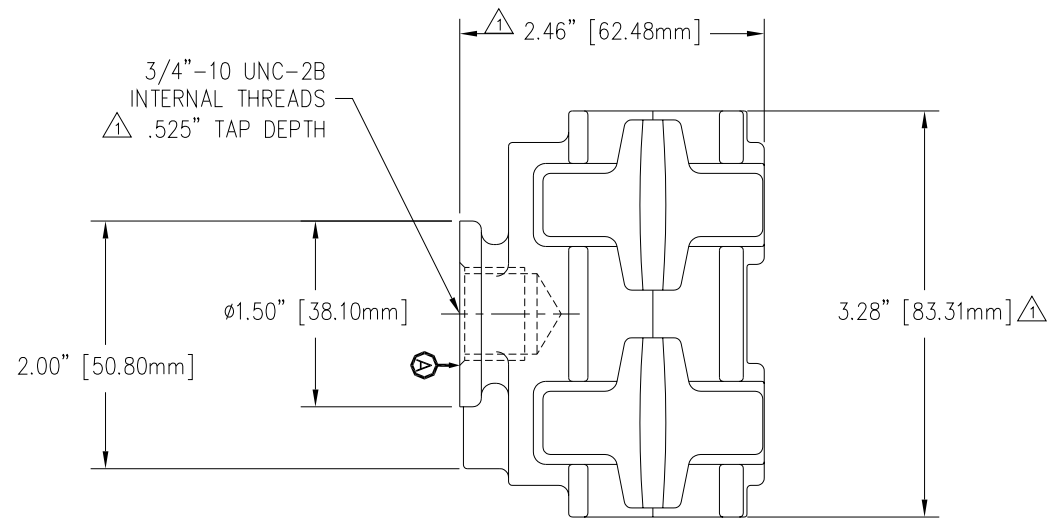
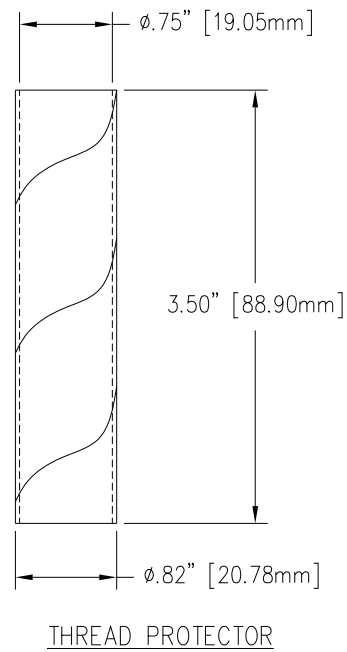
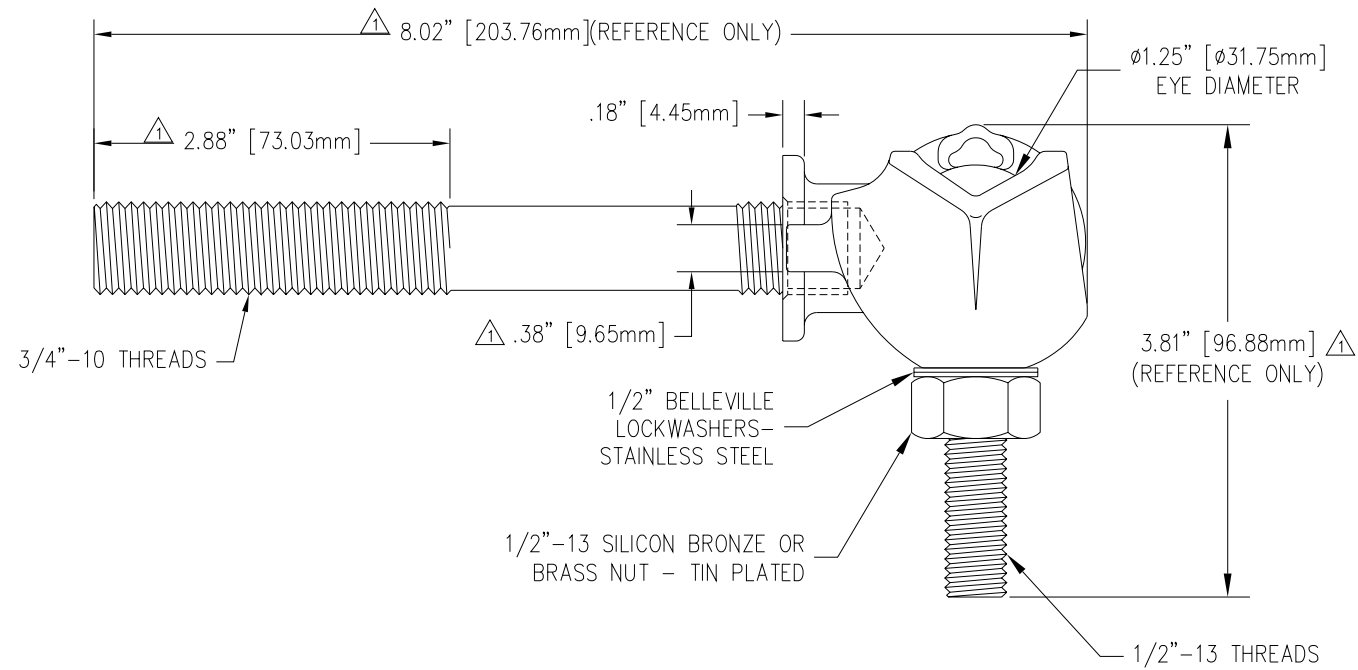

MATERIAL:
 CAP - CDA 84400 TIN PLATED
 STUD - COPPER CDA 11000
 EYEBOLT - CDA 95500 TIN PLATED

- NOTES:
1. BOTTOM VIEW SHOWN WITHOUT STUD FOR DIMENSIONING.
 2. FULL THREAD FROM SURFACE TO THE DEPTH SPECIFIED IN THE TAP NOTE.
 3. MINIMUM BACKOUT TORQUE - 85 FT. LBS

TOLERANCES (EXCEPT AS NOTED) DECIMAL $\pm .032" / .8mm$ FRACTIONAL \pm ANGULAR $\pm 2'$			H-J ENTERPRISES, INC. 3010 HIGH RIDGE BLVD. HIGH RIDGE, MO. 63049 USA PHONE 1-636-677-3421 FAX 1-636-376-1915			
			100 KVA TERMINAL BODY, EYEBOLT, AND 3/4"-10 STUD ASSEMBLY			
	MATERIAL (SEE DRAWING)		CHK'D	APP'D	DRAWING NO. AS1058-015	
	DRAWN BY CJT	DATE 11-18-98	SCALE N.T.S.			