

REVISIONS					
NO.	DATE	ECN #	REMARKS	BY	APPD.
1	1-3-00		EDITED AND ADDED DIMS. AND ADDED TAP DEPTH.	CJT	LHE
2	3-9-04	HJ04-050	ADDED A NOTE	JRM	SP

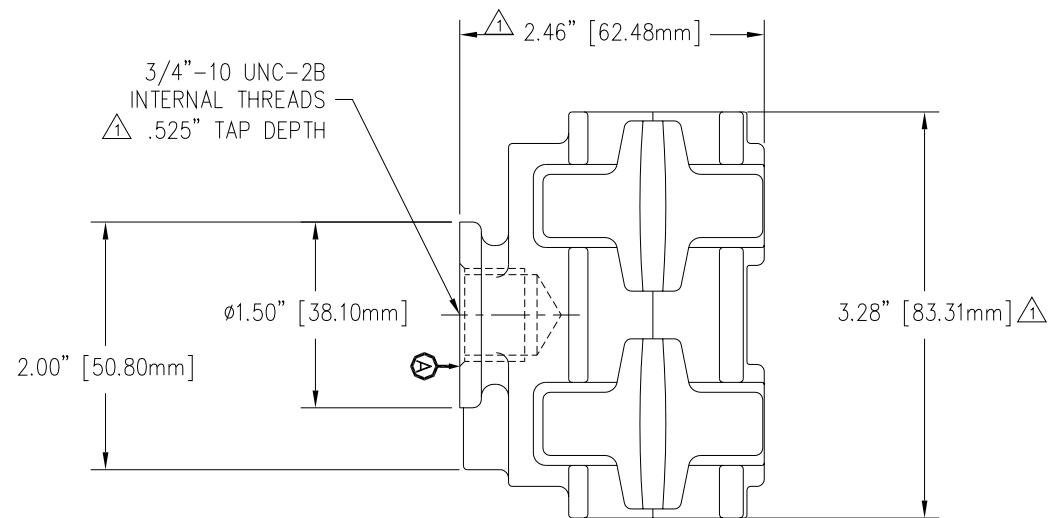
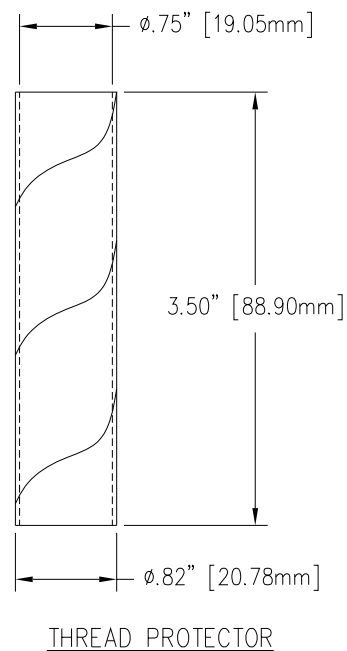
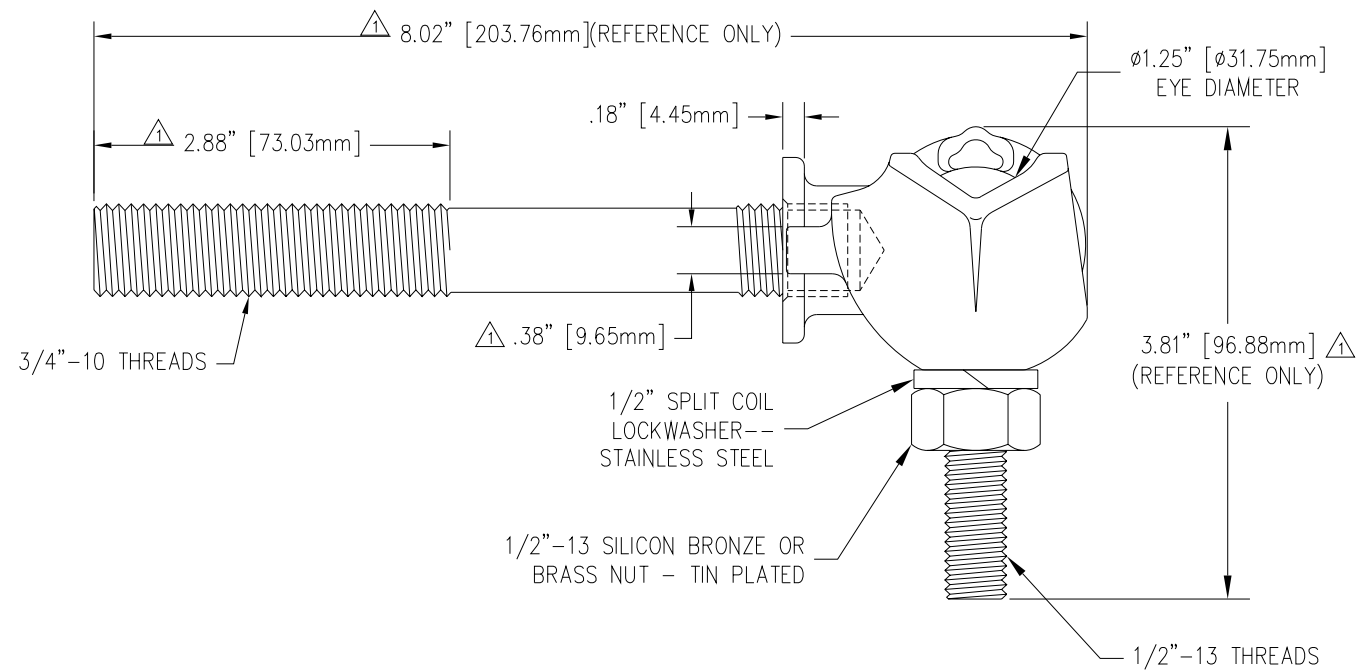

MATERIAL:  
 CAP - CDA 84400 TIN PLATED  
 STUD - COPPER CDA 11000  
 EYEBOLT - CDA 95500 TIN PLATED

- NOTES:
1. BOTTOM VIEW SHOWN WITHOUT STUD FOR DIMENSIONING.
  2. FULL THREAD FROM SURFACE  $\text{\textcircled{A}}$  TO THE DEPTH SPECIFIED IN THE TAP NOTE.
  3. MINIMUM BACKOUT TORQUE - 85 FT. LBS  $\text{\textcircled{\Delta}}$

TOLERANCES (EXCEPT AS NOTED) DECIMAL $\pm .032" / .8\text{mm}$ FRACTIONAL $\pm$ ANGULAR $\pm 2'$		<b>H-J ENTERPRISES, INC.</b> 3010 HIGH RIDGE BLVD, HIGH RIDGE, MO. 63049 USA PHONE 1-636-677-3421 FAX 1-636-376-1915	
		100 KVA TERMINAL BODY, EYEBOLT, AND 3/4"-10 STUD ASSEMBLY	
		MATERIAL (SEE DRAWING)	
		CHK'D DATE 11-18-98	APP'D SCALE N.T.S.