

REVISIONS					
REV	DATE	ECN #	DESCRIPTION	BY	APPD
1	8/30/2012	HJ12-159	REDREW, ADDED SHANK-END CHAMFER DETAIL	CLS	JFS

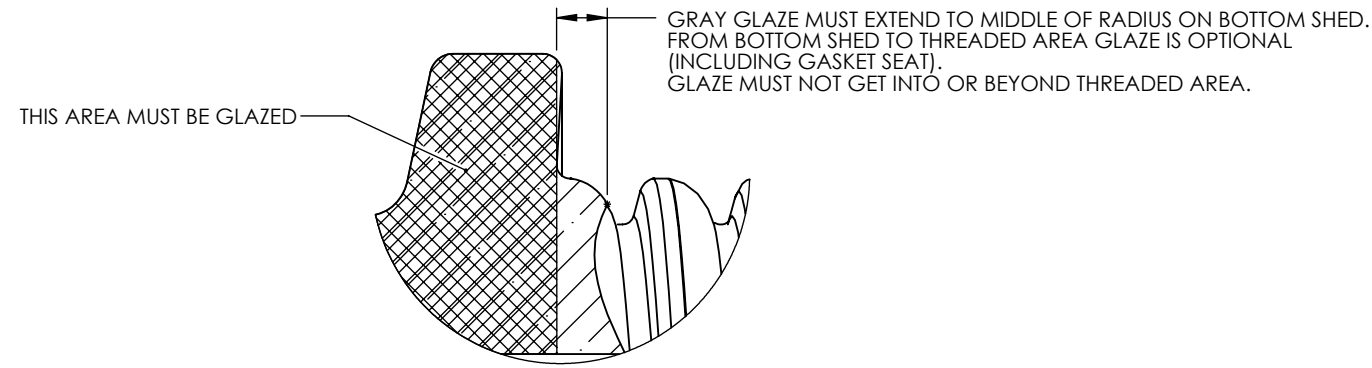

DETAIL A  
SCALE 1:1

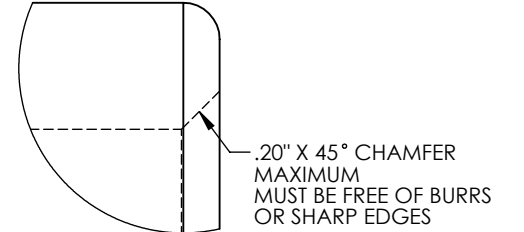

OPTIONAL SHANK-END  
CONFIGURATION

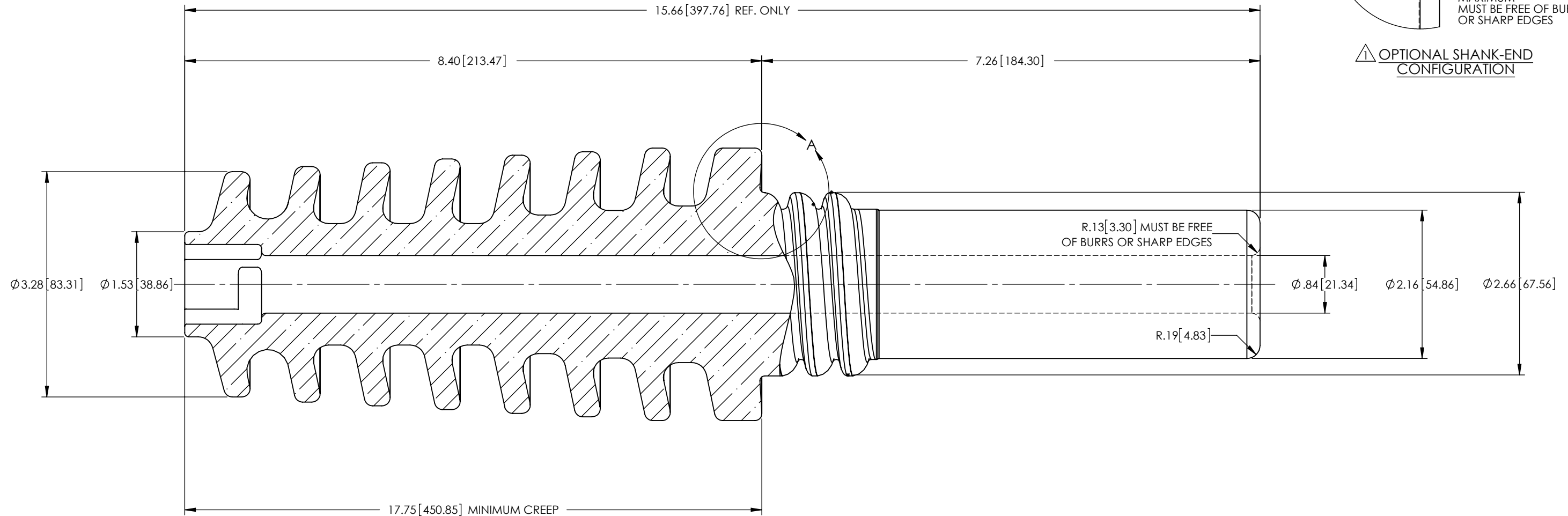

PORCELAIN NOTES:  
 1. GRAY GLAZE MUNSELL 5BG 7.0/0.4  
 2. TOLERANCE ±3% WITH NOTHING LESS THAN ±.03", UNLESS OTHERWISE NOTED ON DRAWING.

**PROPRIETARY AND CONFIDENTIAL**  
 THE INFORMATION CONTAINED IN THIS DRAWING IS THE SOLE PROPERTY OF H-J INTERNATIONAL, INC. ANY REPRODUCTION IN PART OR AS A WHOLE WITHOUT THE WRITTEN PERMISSION OF H-J INTERNATIONAL, INC. IS PROHIBITED.

TOLERANCES (EXCEPT AS NOTED)	
DECIMAL	+/-
FRACTIONAL	+/-
ANGULAR	+/- 2 Degrees



H-J INTERNATIONAL, INC.  
 3010 HIGH RIDGE BLVD. HIGH RIDGE, MO. 63049 USA  
 PHONE 1-636-677-3421 FAX 1-636-376-1915

18kV H.V. PORCELAIN

MATERIAL WET PROCESS ELECTRICAL PORCELAIN

DRAWN BY JH

DATE 07/17/2009

APP'D 8/30/12  
 SCALE N.T.S.

DRAWING NO.  
 P00017-003