

REVISIONS					
NO	DATE	ECN#	REMARKS	BY	APPD.
1	10/16/02		DIM .79 WAS .88	DB	RM
2	10/01/2003		E07 WAS E04	DB	RM
3	5/21/03		E09 WAS E07	DB	RM

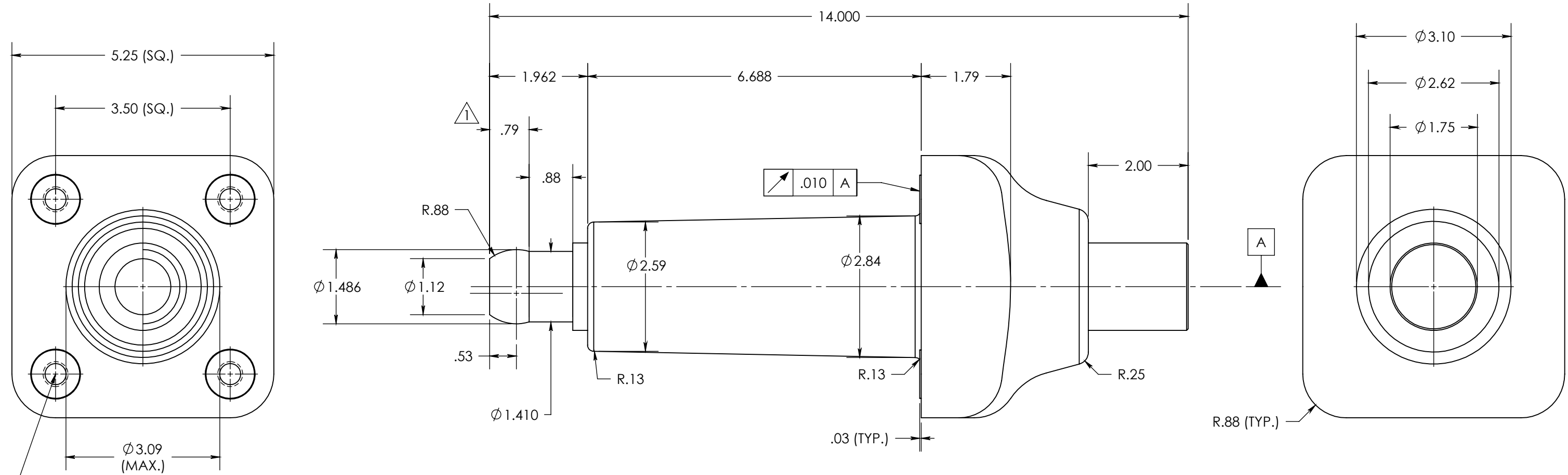

1/2-13 UNC X 1.00DP  
BRASS MOUNTING INSERT

- NOTES:  
1. ALL CONTACT SURFACES TO BE CLEAN & FREE FROM FLASH
- MATERIAL:  
1. E09 - CYCLOALIPHATIC EPOXY (OUTDOOR)  
2. E06 - BISPHENOL-A EPOXY (INDOOR)  
3. HD ETP COPPER, C11000; FINISH SILVER PLATED .0005 MIN. THICKNESS
- SPECIFICATIONS:  
1. RATED VOLTAGE ..... 5kV  
2. POWER FREQUENCY WITHSTAND ..... 19kV  
3. BASIC IMPULSE LEVEL ..... 60KV  
4. NOMINAL CURRENT RATING ..... 1200 AMPS  
5. LEAKAGE DISTANCE ..... 4.25"  
6. TEMPERATURE CLASSIFICATION..... -50°C TO +105°C  
7. FINISHED WEIGHT ..... 15.7 LBS.

**PROPRIETARY AND CONFIDENTIAL**  
THE INFORMATION CONTAINED IN THIS DRAWING IS THE SOLE PROPERTY OF H-J INTERNATIONAL, INC. ANY REPRODUCTION IN PART OR AS A WHOLE WITHOUT THE WRITTEN PERMISSION OF H-J INTERNATIONAL, INC. IS STRICTLY PROHIBITED.

**BREAK ALL SHARPS UNLESS OTHERWISE NOTED**

**TOLERANCES (EXCEPT AS NOTED)**  
ONE PLACE MM ±1.50  
TWO PLACE MM ±0.75  
TWO PLACE DEC. ±.060  
THREE PLACE DEC. ±.030  
FRACTIONS ± 1/16"  
ANGLES 2°



**H-J INTERNATIONAL, INC.**  
3010 HIGH RIDGE BLVD, HIGH RIDGE, MO. 63049 USA  
PHONE 1-636-677-3421 FAX 1-636-376-1915

**5kV, 1200A SWITCHGEAR BUSHING**

DRAWING NO. **15-015-001**

SCALE 1:2 SIZE B REV. 3 SHEET 1 OF 1

APPROVED BY	DB	DATE	10-10-01
CHECKED BY	RM	DATE	10-10-01
DRAWN BY	DB	DATE	10-5-01
TOOL NO.	T15-015-0		
PRODUCT GRP.	1500 SERIES		