

REVISIONS					
REV.	DATE	ECN#	DESCRIPTION	BY	APPROVED
1	2/19/2016	PQI# 8786	ADDED C'BORE TOL., REM. METRIC SHEET TOL., REV. 2- & 3-PLACE DEC. TOL.	CLS	BLB
2	6/21/2016	PQI# 8786	ADDED MATERIALS, WAS "Q8786-EPC-01"	CLS	
3	9/16/2016	HJ16-189	ADDED NOTE 5 (60Hz, 20kV, 10s WITHSTAND)	CLS	BLB

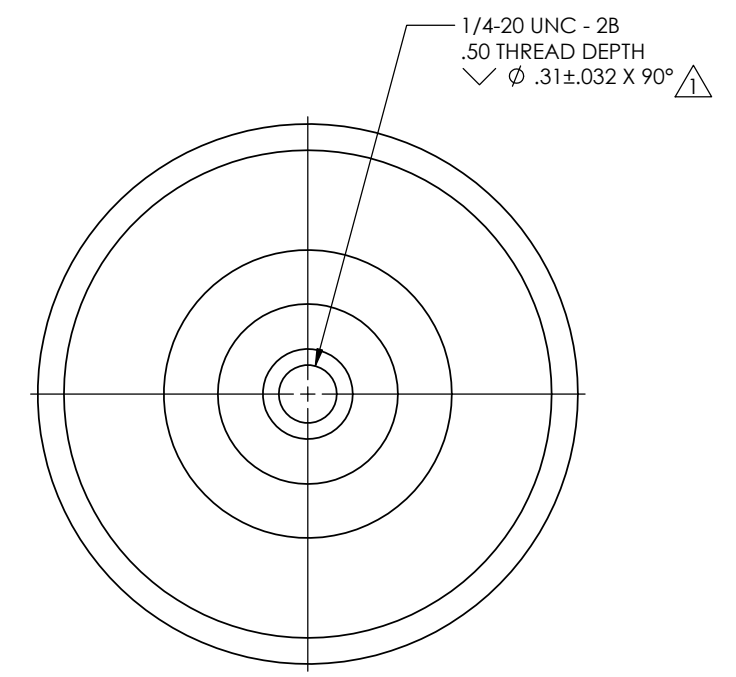
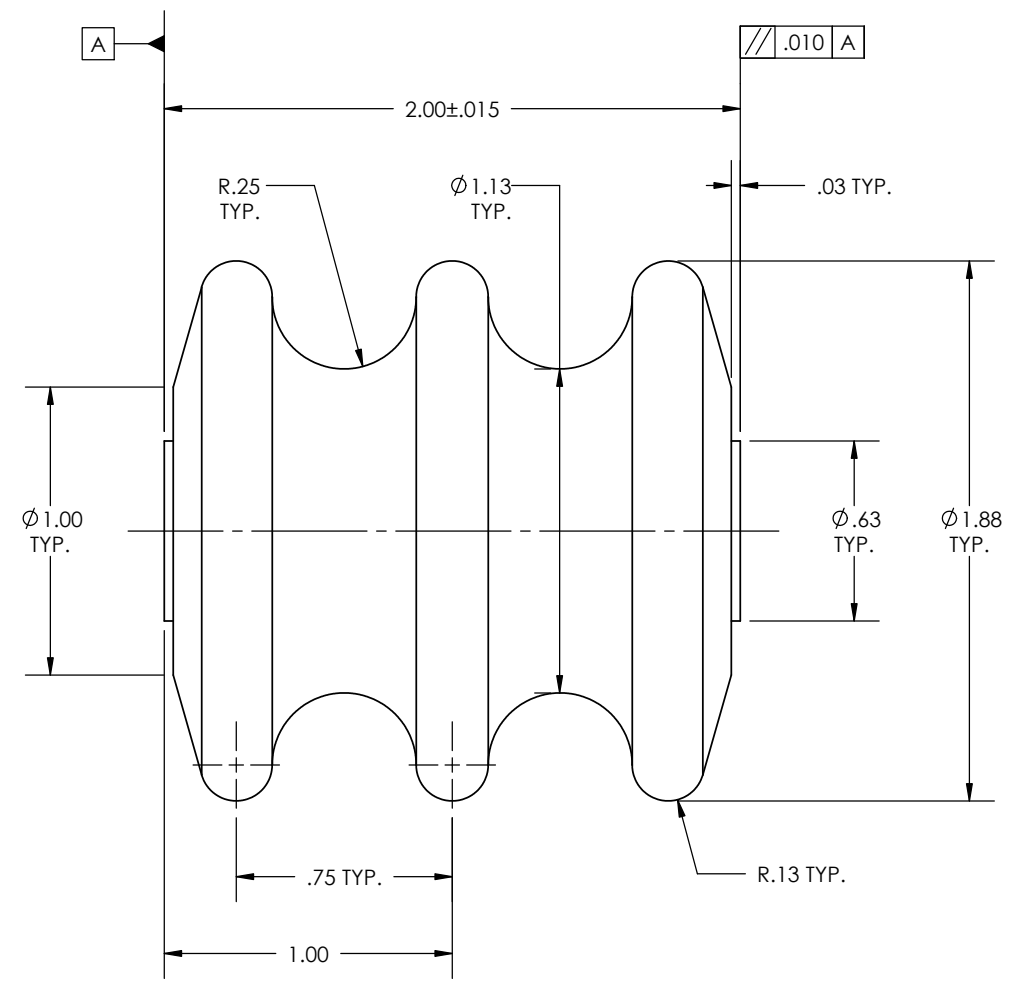
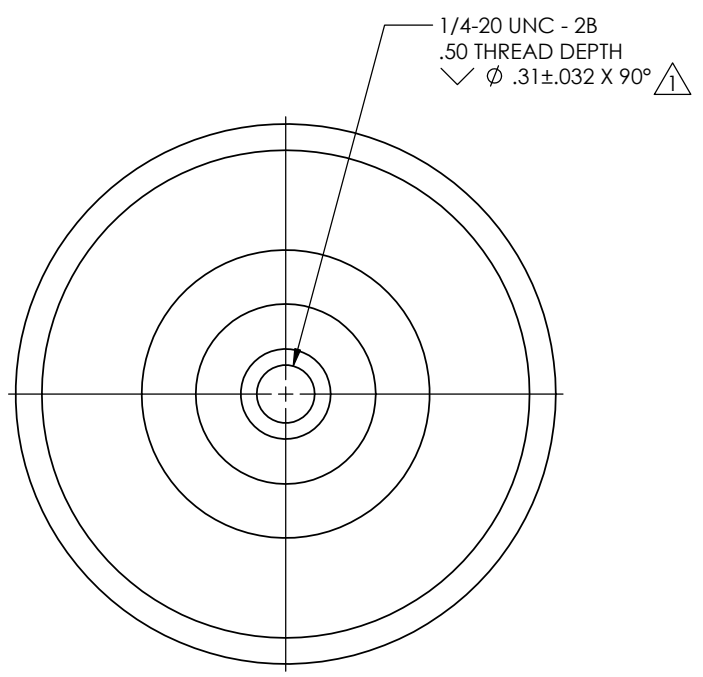

2 MATERIALS:  
 E07 - CYCLOALIPHATIC EPOXY, GREY (OUTDOOR)  
 C36000 BRASS INSERTS

- NOTES:
1. INSERTS MUST BE IN LINE WITHIN .017"
  2. INSULATOR MUST WITHSTAND AC VOLTAGE OF 30kV, 60 Hz FOR 1 MINUTE BETWEEN INSERTS.
  3. LEAKAGE DISTANCE FROM INSERT TO INSERT IS 3.563" MIN.
  4. INSULATOR MUST HAVE A MINIMUM OF 1500 LBS. TENSILE STRENGTH.
  5. INSULATOR MUST WITHSTAND 60Hz VOLTAGE 20kV BETWEEN INSERTS FOR 10 SECONDS EITHER ON A SWITCH OR SHIPPED SEPARATELY.

**PROPRIETARY AND CONFIDENTIAL**  
 THE INFORMATION CONTAINED IN THIS DRAWING IS THE SOLE PROPERTY OF H-J INTERNATIONAL, INC. ANY REPRODUCTION IN PART OR AS A WHOLE WITHOUT THE WRITTEN PERMISSION OF H-J INTERNATIONAL, INC. IS STRICTLY PROHIBITED.  
 BREAK ALL SHARPS UNLESS OTHERWISE NOTED

TOLERANCES (EXCEPT AS NOTED)  
 TWO PLACE DEC. ±.02  
 THREE PLACE DEC. ±.005  
 FRACTIONS ± 1/16"  
 ANGLES 2°



**H-J INTERNATIONAL, INC.**  
 3010 HIGH RIDGE BLVD, HIGH RIDGE, MO. 63049 USA  
 PHONE 1-636-677-3421 FAX 1-636-376-1915

STAND OFF INSULATOR

APPROVED BY	---	DATE	---/---/---
CHECKED BY	---	DATE	---/---/---
DRAWN BY	CLS	DATE	12/11/2015
TOOL NO.	T02-300-000		
PRODUCT GRP.	200 SERIES		

DRAWING NO. **02-300-000**  
 SCALE **3:2** SIZE **B** REV. **3** SHEET **1** OF **1**