

REVISIONS					
REV.	DATE	ECN #	DESCRIPTION	BY	APP'D

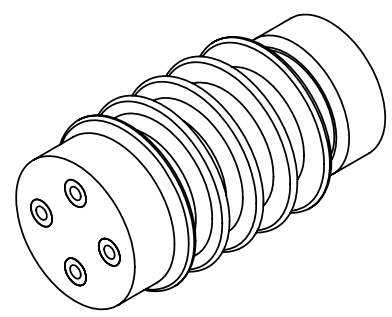
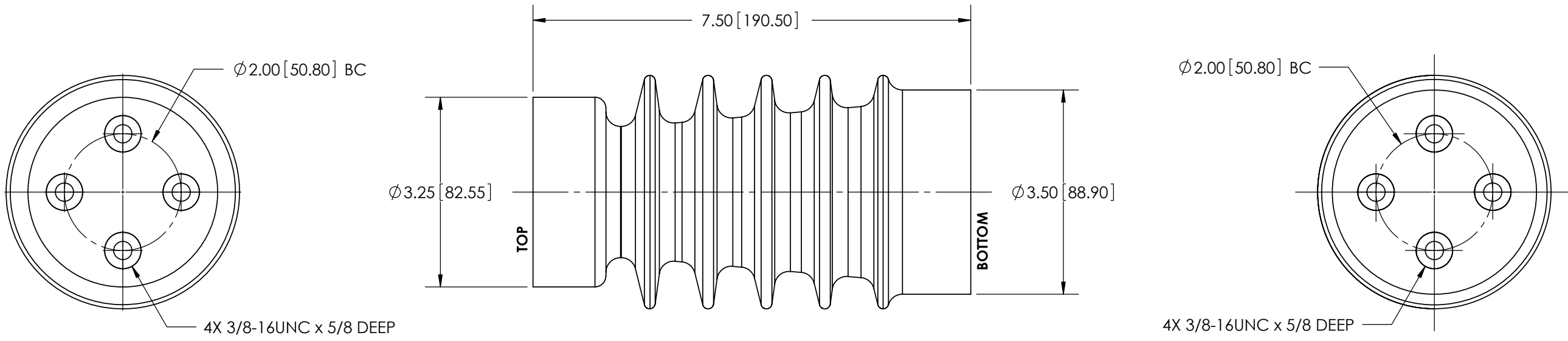

ALL INSERTS ARE AISI 12L14 STEEL MATERIAL & ZINC PLATED.

MATERIAL: E01 - BISPHENOL-A (GREY)
E07 - CYCLOALIPHATIC (GREY)

TYPES OF SPECIALS AVAILABLE UPON REQUEST (THROUGH SALES DEPT):
NON-STANDARD CONFIGURATIONS
UNF (FINE) & METRIC THREADS

FOR "BIL" RATINGS 95KV AND HIGHER, ALL INSERT CONFIGURATIONS WITH 3 OR MORE INSERTS
ON EITHER END, WILL BE INTERNALLY CONNECTED (COMMON), ALLOWING FOR SELECTIVE APPLICATIONS.

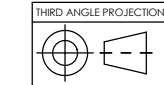

PROPRIETARY AND CONFIDENTIAL
THE INFORMATION CONTAINED IN THIS DRAWING IS THE SOLE PROPERTY OF H-J INTERNATIONAL, INC. ANY REPRODUCTION IN PART OR AS A WHOLE WITHOUT THE WRITTEN PERMISSION OF H-J INTERNATIONAL, INC. IS STRICTLY PROHIBITED.

BREAK ALL SHARPS UNLESS OTHERWISE NOTED

TOLERANCES (EXCEPT AS NOTED)	
ONE PLACE MM	±1.50
TWO PLACE MM	±0.75
TWO PLACE DEC.	±.060
THREE PLACE DEC.	±.030
FRACTIONS	± 1/16"
ANGLES	2°

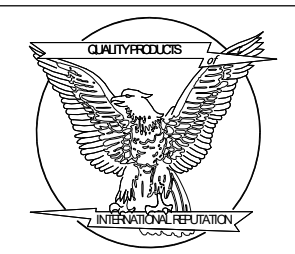

APPROVED BY	DB	DATE	11/12/2008
CHECKED BY	DB	DATE	11/12/2008
DRAWN BY	SMM	DATE	11/11/2008
TOOL NO.	T02-003-0		
PRODUCT GRP.	200 SERIES		

H-J INTERNATIONAL, INC.
3010 HIGH RIDGE BLVD, HIGH RIDGE, MO. 63049 USA
PHONE 1-636-677-3421 FAX 1-636-376-1915

20KV INDOOR / OUTDOOR INSULATOR
A20 UNIFORM STRENGTH CLASS
110KV BIL

DRAWING NO.	02-003-022		
SCALE	1:2	SIZE	B
REV.	0	SHEET	1 OF 1