

REVISIONS					
NO	DATE	ECN#	REMARKS	BY	APPD.

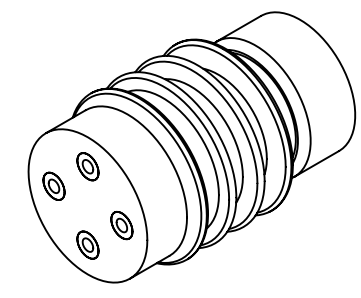
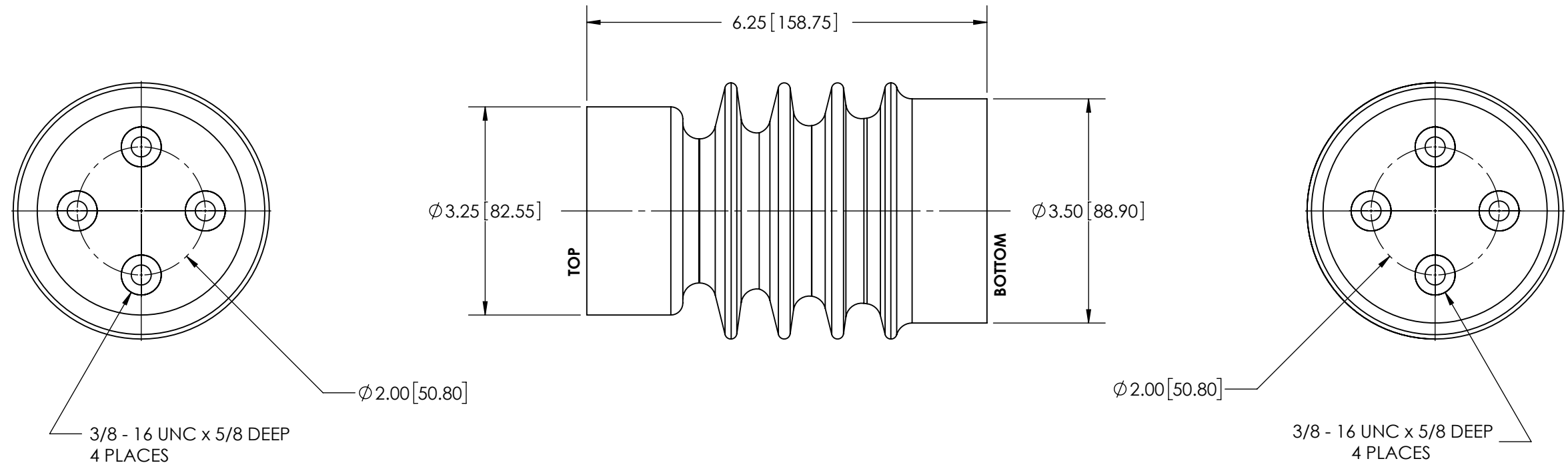

ALL INSERTS ARE AISI 12L14 STEEL MATERIAL & ZINC PLATED.

MATERIAL: E01 - BISPHENOL-A (GREY)  
E07 - CYCLOALIPHATIC (GREY)

TYPES OF SPECIALS AVAILABLE UPON REQUEST (THROUGH SALES DEPT):  
NON-STANDARD CONFIGURATIONS  
UNF (FINE) & METRIC THREADS

FOR "BIL" RATINGS 95KV AND HIGHER, ALL INSERT CONFIGURATIONS WITH 3 OR MORE INSERTS ON EITHER END, WILL BE INTERNALLY CONNECTED (COMMON), ALLOWING FOR SELECTIVE APPLICATIONS.

**PROPRIETARY AND CONFIDENTIAL**  
THE INFORMATION CONTAINED IN THIS DRAWING IS THE SOLE PROPERTY OF H-J INTERNATIONAL, INC. ANY REPRODUCTION IN PART OR AS A WHOLE WITHOUT THE WRITTEN PERMISSION OF H-J INTERNATIONAL, INC. IS STRICTLY PROHIBITED.  
BREAK ALL SHARPS UNLESS OTHERWISE NOTED

**TOLERANCES (EXCEPT AS NOTED)**  
ONE PLACE MM  $\pm 1.50$   
TWO PLACE MM  $\pm 0.75$   
TWO PLACE DEC.  $\pm .060$   
THREE PLACE DEC.  $\pm .030$   
FRACTIONS  $\pm 1/16"$   
ANGLES  $2^\circ$

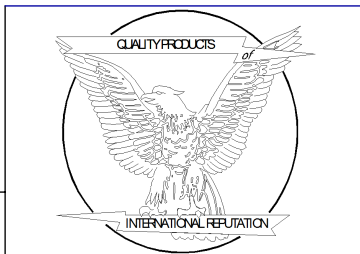

APPROVED BY	CJT	DATE	03/22/2016
CHECKED BY	CJT	DATE	03/22/2016
DRAWN BY	CLS	DATE	03/22/2016
TOOL NO.	T02-002-0		
PRODUCT GRP.	200 SERIES		

**H-J INTERNATIONAL, INC.**  
3010 HIGH RIDGE BLVD, HIGH RIDGE, MO. 63049 USA  
PHONE 1-636-677-3421 FAX 1-636-376-1915

<i>15kV INDOOR / OUTDOOR INSULATOR</i>			
<i>A20 UNIFORM STRENGTH CLASS</i>			
<i>95kV BIL</i>			
DRAWING NO.		<b>02-002-022-L</b>	
SCALE	1:2	SIZE	B
REV.	0	SHEET	1 OF 1