

REVISIONS					
REV.	DATE	ECN#	DESCRIPTION	BY	APPROVED
1	2/08/2002		Ø .56" HOLE WAS Ø .50"; MODIFIED SPADE CUT-OUT.	DB	RM
2	4/12/2002		MATERIAL WAS 6061 ALUMINUM.	DB	RM
3	1/09/2003		CHANGED TO STAMPED CLAMP, MATERIAL WAS 5052 ALUMINUM; DIM 3.00" WAS 2.75", 4.25" WAS 4.38", .80" WAS .56"	DB	RM
4	9/24/2004		ADDED A, B, & C SERIES FOR DIFFERENT MAT'L AND SUPPLIERS.	DB	RM
5	11/04/2005		REDESIGNED IN A356; MATERIAL WAS 5052/6061.	DB	RM
6	3/20/2009	HJ09-066	CONVERTED TO HJE TEMPLATE; MATERIAL WAS 356.0 ALUMINUM.	JH	JFS

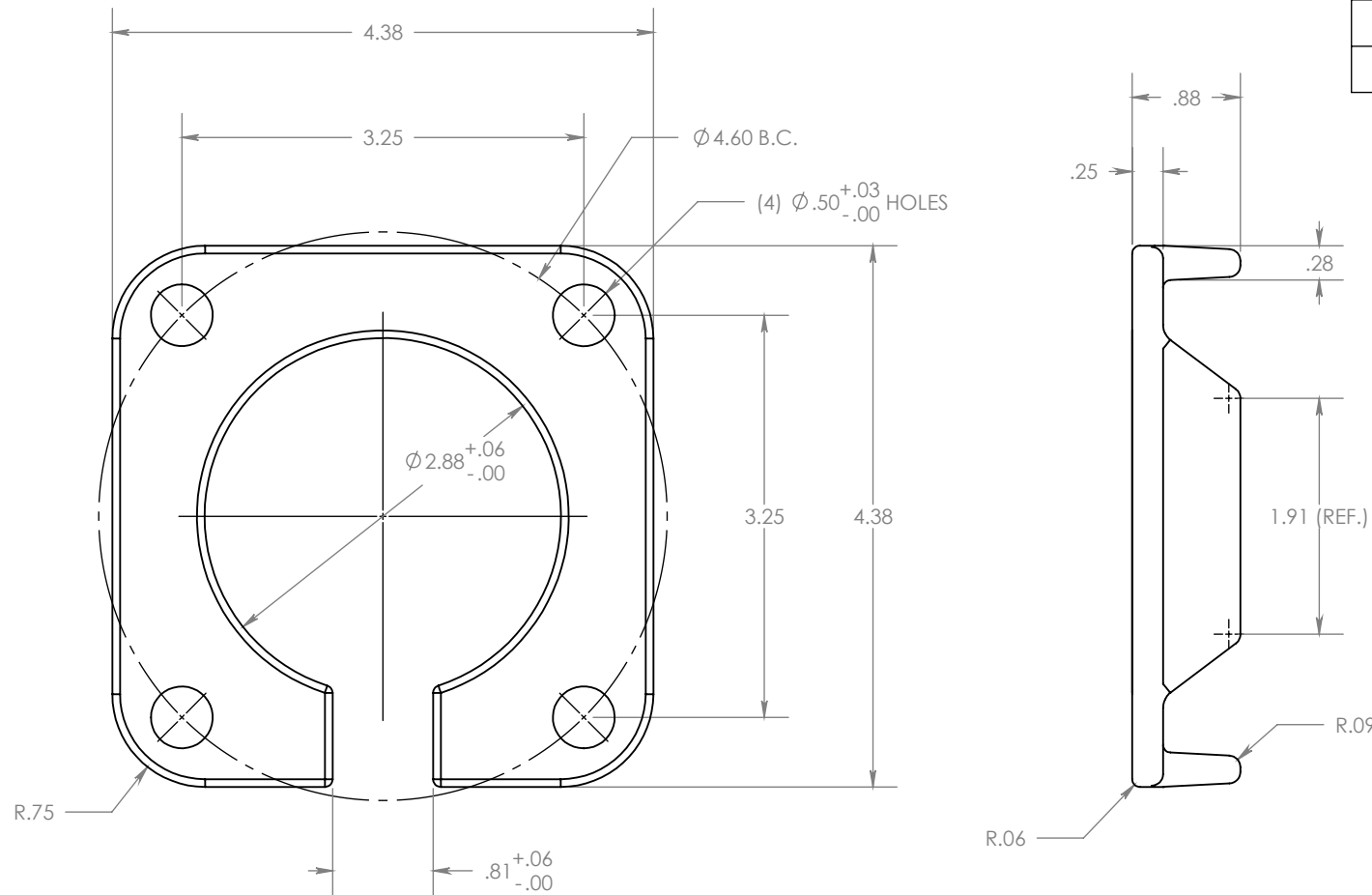

NOTES:

1. REMOVE ALL FLASHING AND SHARP EDGES
2. 3° DRAFT PERMISSIBLE ALL OVER

MATERIAL: ALUMINUM 356.0 PERMANENT MOLD CAST

PROPRIETARY AND CONFIDENTIAL
 THE INFORMATION CONTAINED IN THIS DRAWING IS THE SOLE PROPERTY OF H-J ENTERPRISES, INC. ANY REPRODUCTION IN PART OR AS A WHOLE WITHOUT THE WRITTEN PERMISSION OF H-J ENTERPRISES, INC. IS PROHIBITED.

TOLERANCES (EXCEPT AS NOTED)

DECIMAL	+/- .032"/.8mm
FRACTIONAL	+/-
ANGULAR	+/- 2 Degrees



H-J ENTERPRISES, INC.
 3010 HIGH RIDGE BLVD. HIGH RIDGE, MO. 63049 USA
 PHONE 1-636-677-3421 FAX 1-636-376-1915

LV BUSHING CLAMP

MATERIAL A356-T6 ALUMINUM

CHK'D APP'D SCALE N.T.S.

DRAWING NO. CO-5047-00

DRAWN BY DB DATE 6/3/1999