

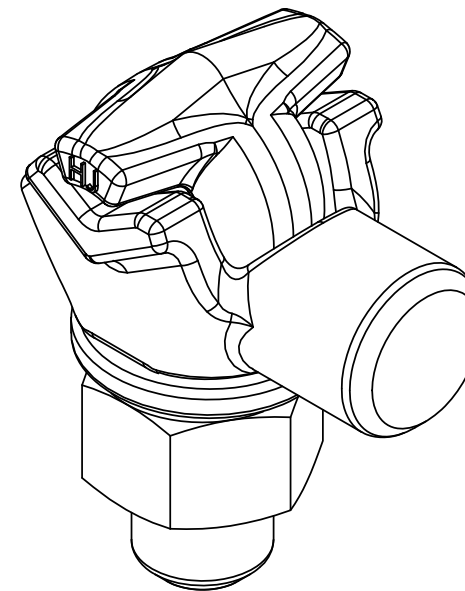

REVISIONS					
REV.	DATE	ECN #	DESCRIPTION	BY	APPROVED
1	3-25-97		NUT IS TIN PLATED.	BTD	LHE
2	11-9-99		REDRAWN & REDIMENSIONED.	CJT	LHE
3	9-17-08	HJ08-167	CHANGED MATERIAL	CJT	LHE
4	3-6-09	HJ08-167	BODY REDRAWN	JH	JFS
5	4/30/2014	HJ14-051	CHANGED TERMINAL BODY MATERIAL	CLS	BLB
6	8/13/2021	HJ21-061	CHANGED BODY MATERIAL	MAD	BG



MATERIAL:
 BODY - C84400 TIN PLATED
 EYEBOLT - C95500 TIN PLATED

PROPRIETARY AND CONFIDENTIAL
 THE INFORMATION CONTAINED IN THIS DRAWING IS THE SOLE PROPERTY OF H-J ENTERPRISES, INC. ANY REPRODUCTION IN PART OR AS A WHOLE WITHOUT THE WRITTEN PERMISSION OF H-J ENTERPRISES, INC. IS PROHIBITED.

TOLERANCES (EXCEPT AS NOTED)	
DECIMAL	+/- .032"/.8mm
FRACTIONAL	+/-
ANGULAR	+/- 2 Degrees



H - J ENTERPRISES, INC.
 3010 HIGH RIDGE BLVD. HIGH RIDGE, MO. 63049 USA
 PHONE 1-636-677-3421 FAX 1-636-376-1915

GROUND TERMINAL #10 STR. - #1 STR.

MATERIAL (SEE DRAWING)

CHK'D CJT APP'D 04/30/14
 SCALE N.T.S.

DRAWING NO.
AS1004-003

DRAWN BY TLH DATE 4-11-96